

HEARST ELEMENTARY SCHOOL DROP-OFF / PICK-UP PROCEDURES

We have been working with the City of Pleasanton to improve safety associated with the drop-off and pick-up of students at Hearst Elementary School. Our joint efforts are part of "Rides to School," Pleasanton's School Traffic Calming Program. **The following procedures will go into effect the first day of school.**

The primary unloading/loading area is within the parking lot; refer to the circulation map located on the back. School staff will be present at the beginning of the school year to orient new parents to the operation. Vehicles enter the loop from the eastern driveway located between Pleasanton Middle School and Hearst Elementary School on Case Avenue. Upon entering, there are two lanes to access the drop off areas. The right lane will lead vehicles to Drop off Area B at the back of the school. The left lane will lead vehicles to Drop off Area A. Once you enter a lane, you must proceed to the designated drop off area. **In both cases, the curb lane is the only lane that should be used for loading and unloading.** School staff will assist in directing cars forward as they enter the loading area in both zones.

After unloading or loading of passengers, vehicles in both drop off zones must wait until the vehicle in front of them proceeds forward to exit. This platooning method helps reduce cars pulling in and out of the loading zone and interrupting the flow of traffic. The vehicles that initially went straight to Drop off Area B should turn right and proceed past Drop off Area A to exit. Two lanes will develop into one veering right toward the exit that opens to Case Avenue. There are no left turns onto Case Avenue from the exit. Upon entering Case Avenue, drivers should continue to the signalized intersection at Valley Avenue.

For those students and parents who are walking to school, we ask that you use the preferred crosswalks manned by the crossing guard noted below on Case Avenue and adhere to the crossing guard's or staff's directions on when to cross to help improve traffic flow and safety. We also ask that parents and students refrain from using the handicapped crosswalk marked in blue in front of the office so as to not interrupt the flow of traffic exiting the school.

Valley Avenue at Case Avenue Intersection

Pedestrians are encouraged to cross Case Avenue at Crosswalk #2 on back map. **Those arriving or departing from Hearst Elementary are advised to use the Case Avenue mid-block crosswalk that is staffed by a crossing guard during the school peak times and not Crosswalk #3.**

Work is anticipated to begin this coming school year to provide a continuous bike trail from the intersection of Valley Avenue at Case Avenue going eastward to the intersection of Valley Avenue at Sunol Boulevard. Once the bike trail is complete, bicyclists will be able to use crosswalk #2 and crosswalk #1 to access the bike trail. A sidewalk exists on the north side of Valley Avenue, along with on-street bike lanes on both sides of the street.

Please remember that although your child is safely inside the school or in the vehicle, many other students are still walking around and cautious driving is needed at all times. Refraining from cell phone use and adhering to speed limits is advised. We will be monitoring these procedures to evaluate their effectiveness in reducing traffic congestion while ensuring optimum safety for our students. ***Thank you for your cooperation and please drive safely!***

HEARST ELEMENTARY SCHOOL DROP-OFF / PICK-UP PROCEDURES

MAP

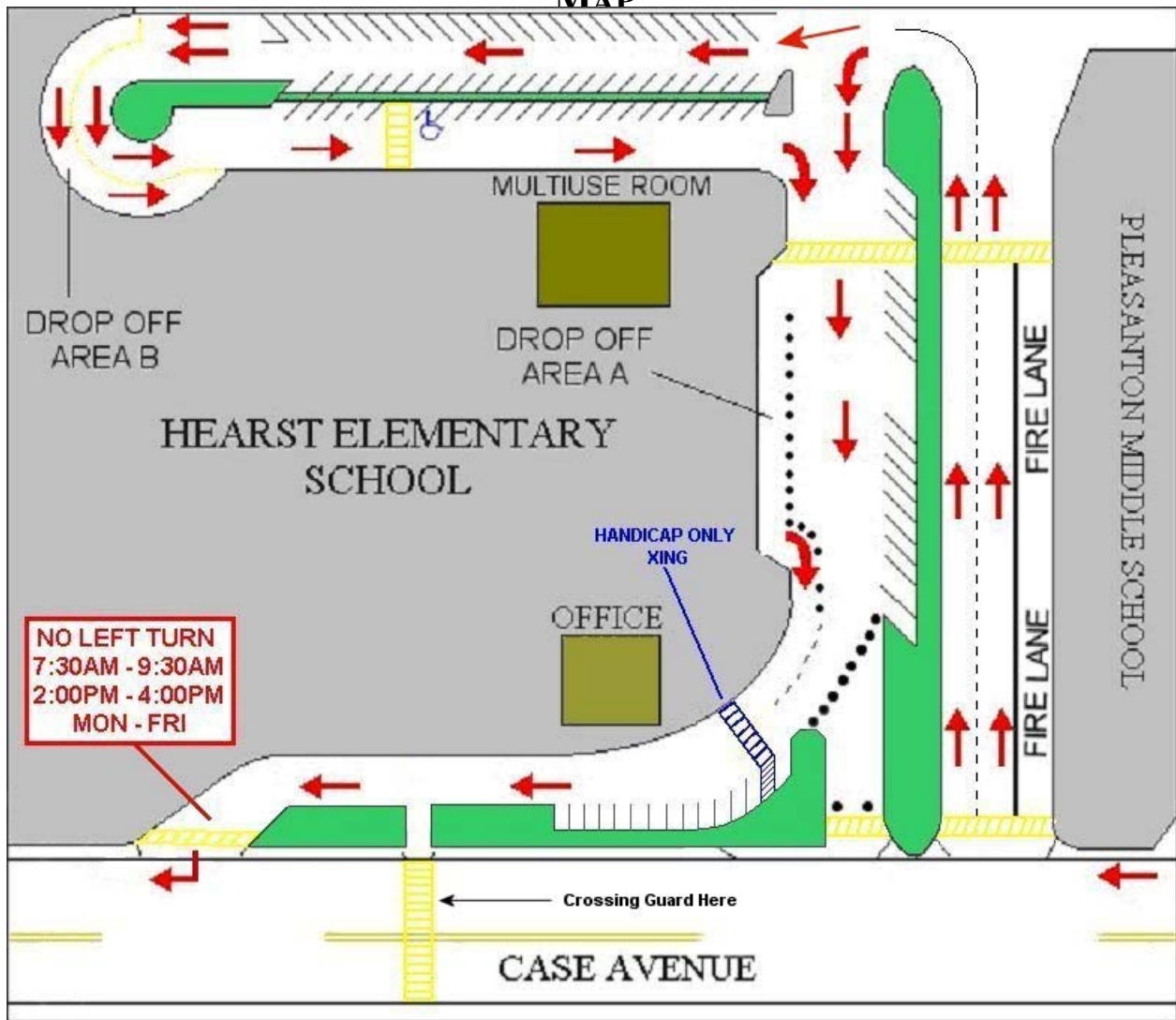

Valley Avenue at
Case Avenue
Intersection

